

Land For Sale • \$7,000/acre

21 acres +/- • Minter Road • Chester County, SC

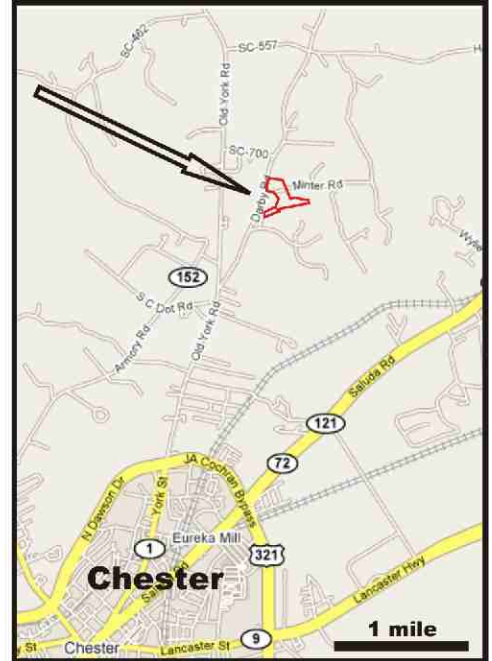
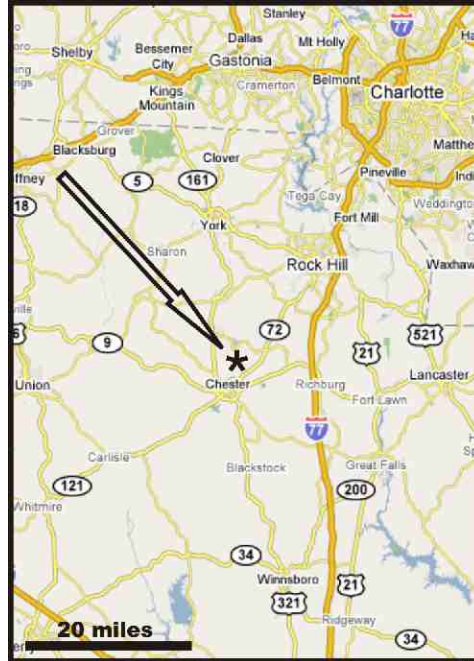

Property Features:

- Paved road frontage
- Covered in pine/hardwood mix
- 40 minutes to Charlotte
- Secluded

This tract is a great spot for the person that wants a little space but doesn't want to be too far out of town. Five minutes from Chester, fifteen minutes to Rock Hill, forty minutes to Charlotte. *Owner will consider subdividing into smaller parcels.*

For more information contact:

Tim Cartner

T. 704.996.0380

tim@thelandcompanyllc.com

The Land Company, LLC
156 East Main Street
Suite 3
Rock Hill, SC 29730

www.thelandcompanyllc.com

THE LAND

COMPANY, LLC
Real Estate Brokerage Services



Disclaimer: The information provided herein is deemed reliable, but is not guaranteed in any way. It is the responsibility of the buyer to perform his or her own evaluation.

Land For Sale • \$7,000/acre

21 acres +/- • Minter Road • Chester County, SC

Topography - 10 foot contours

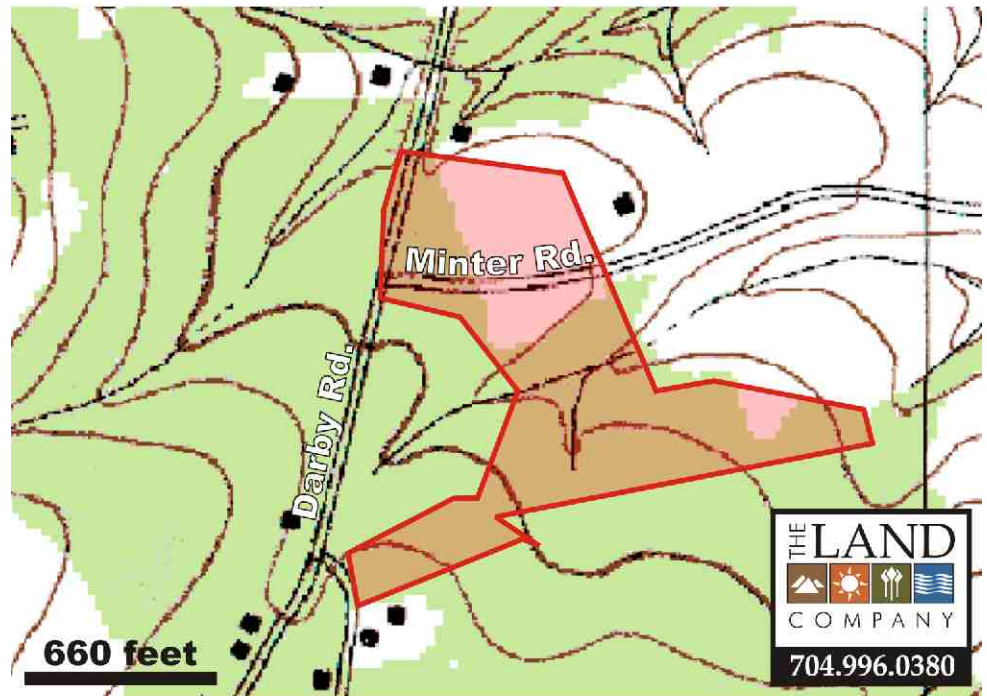

2006 Infrared Aerial Photograph



For more information contact:

Tim Cartner

T. 704.996.0380

tim@thelandcompanyllc.com

The Land Company, LLC
156 East Main Street
Suite 3
Rock Hill, SC 29730

www.thelandcompanyllc.com

THE LAND
COMPANY, LLC
Real Estate Brokerage Services

Disclaimer: The information provided herein is deemed reliable, but is not guaranteed in any way. It is the responsibility of the buyer to perform his or her own evaluation.